



Innovation Meets Energy Efficient Design

6-Way Electronic Pressure Independent Control Valve

The 6-way electronic pressure independent control valve (EPIV) combines the proven reliability and efficiency of Belimo EPIVs with the streamlined installation of our 6-way characterized control valves.

Uniquely designed for chilled beams, radiant ceiling panels, and 4-pipe fan coil units, this valve achieves true flow and dynamic balancing. By integrating the functionality of multiple valves, it minimizes material requirements and installation time. Available in ½...1" sizes.



Discover the advantages
www.belimo.com

BELIMO[®]

Functional, easy to install and versatile

Features

- Performs changeover and modulating control for a single coil 4-pipe system.
- Provides different flow settings for heating and cooling.
- Zero leakage design minimizes energy loss.
- Reduced material and installation costs.
- Simplifies commissioning with flow measurement and verification (1), electronic flow control (2), and condensation detection via HH1 and HH2 sensors.
- The characterized control valve seals completely (3).

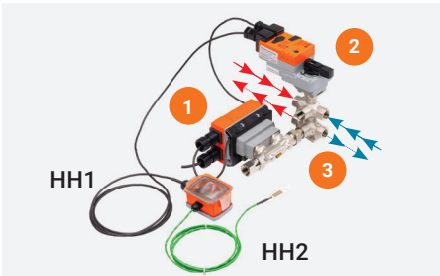

Flexible Control

- Effortless setup with NFC-enabled commissioning and diagnostics via the Belimo Assistant 2 app for optimal device operation.
- Supports Belimo MP-Bus, BACnet MS/TP, Modbus or conventional control signals.

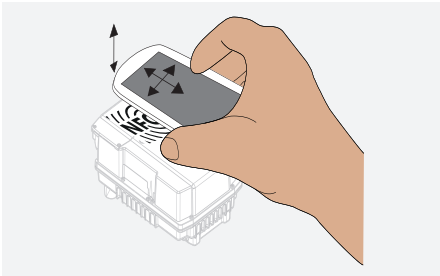

Condensation Management

The condensation management system is designed to be highly responsive and adaptable. A built-in sensor continuously monitors the cooling water inlet pipe for condensation. When condensation is detected, the device enters a warning state which starts a configurable timer, allowing the Building Management System (BMS) time to take corrective action. If the timer expires and the issue persists, the system escalates the warning to an alarm, ensuring proactive prevention of condensation-related problems.

6-way Electronic Pressure Independent Valve (EPIV)

Type	Valve Nominal Size		Flow
	Inches	DN (mm)	V'nom (GPM)
EP050P6+LRX-E EP050P6+LRTX-E HH1 EP050P6+LRTX-E HH2	½	15	5.5
EP075P6+LRX-E EP075P6+LRTX-E HH1 EP075P6+LRTX-E HH2	¾	20	11
EP100P6+NRX-E EP100P6+NRTX-E HH1 EP100P6+NRTX-E HH2	1	25	18.2

Notes:

Medium temperature: 43...180°F [6...82°C]
Close-Off Pressure: 50 psi
Body Pressure: 232 psi

Additional analog input on actuator for the sensor versions - HH1 & HH2

HH1 Condensation Switch, Internal Sensor, LED
HH2 Condensation Switch, External Sensor, Cable length 6.5 ft [2 m], LED